



VILLAGE ESTATES



• EST.1993 •

93 Main Road, Sidcup, Kent DA14 6ND

Tel: 0208 302 1002

www.village-estates.com

Email: sidcup@village-estates.com



OPEN PLAN KITCHEN DINER
SPACIOUS & SECLUDED GARDEN
AVERY HILL PARK

TWO BATHROOMS
DRIVEWAY & GARAGE
SCOPE FOR DORMER EXTENSION



16 Gordon Road
Sidcup, DA15 8SX

£650,000

Village Estates are pleased to present a unique bungalow for sale, nestled away in a quiet residential road not far from Blackfen High Street and close to Avery Hill Park. A versatile property with spacious accommodation on the ground level that leads to a rather large secluded garden. As with every property it is important to have off road parking, this home benefits from an in and out driveway along with a garage.

EPC RATING: F

COUNCIL TAX BAND: E

TENURE: Freehold

LEASE TERM: Not Applicable



Ground Floor

Approx. 140.3 sq. metres (1510.4 sq. feet)



First Floor

Approx. 25.0 sq. metres (269.6 sq. feet)

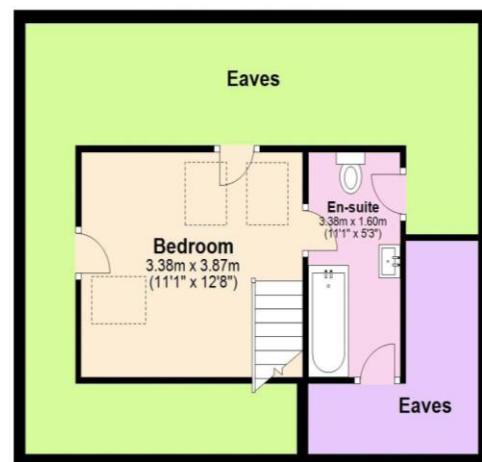

CONSUMER PROTECTION FROM UNFAIR TRADING REGULATIONS 2008

Please note that any services, heating system or appliances have not been tested, and no warranty can be given or implied as to their working order. You are advised to obtain verification from your solicitor or surveyor. References to the tenure of a property are based on information supplied by the seller. We have not had sight of the title documents and a buyer is advised to obtain verification from their solicitor. Items shown in photographs are not included unless specifically mentioned within the sales particulars, but may be available by separate negotiation. Whilst every attempt has been made to ensure the accuracy of the floor plan contained here, measurements of doors, windows, rooms and any other items are approximate and no responsibility is taken for any error, omission, or mis-statement. We advise you to book an appointment to view before embarking on any journey to see a property, and check its availability. The accuracy of these details are not guaranteed and they do not form part of the contract.